



# BOJI

**Length:** 43.00 metres (141' 1")

**Beam:** 9.00 metres (29' 6")

**Draft:** 2.60 metres (8' 6")

**Number of Guests:** 12

**Number of Crew:** 8

**Built:** 2022

**Refit:**

**Builder:** Codecasa

**Naval Architect:** Codecasa

**Flag:** Greek

**Hull Material:** Steel

**Hull Configuration:** Displacement

**Superstructure:**

**Yacht type:**

**Equipment:** Air conditioning, Deck Jacuzzi, Stabilisers at anchor, Stabilisers underway, WiFi connection on board

---

BOJI is a brand new yacht delivered by the renowned Codecasa yard in 2022.

# Key Features

- 1** Large interior and exterior volumes due to her 9.0m beam
- 2** Brand new pedigree yacht
- 3** Beach house style interior flood with light by large windows
- 4** Excellent deck spaces
- 5** Carefully selected, proactive Captain & crew including really excellent chef
- 6** Efficient fuel consumption









Main salon



Main salon



Main salon



Skylounge



Skylounge



Skylounge



Dining



Galley









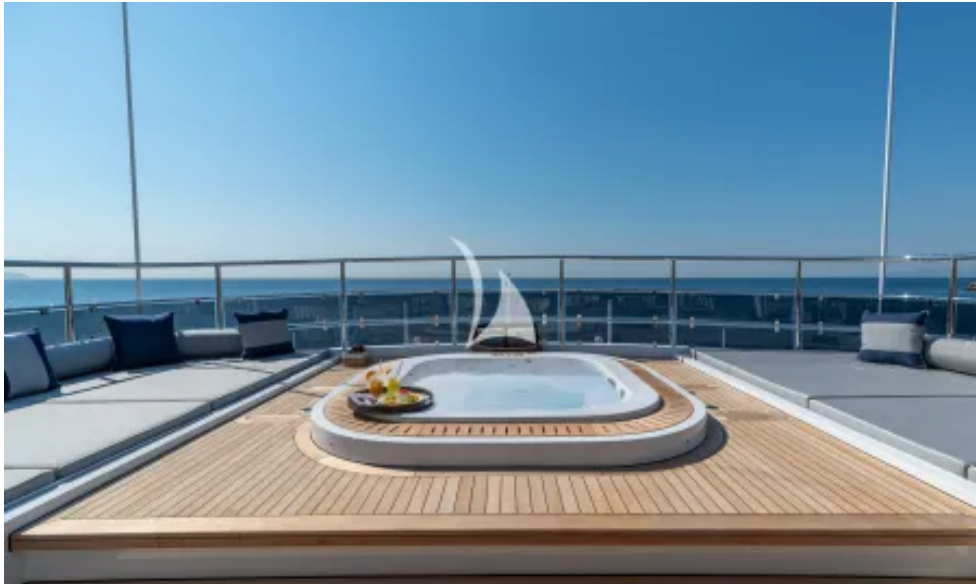





Master stateroom (on main deck)



Master stateroom



Master stateroom





Master stateroom bath



Master stateroom



Master stateroom



Lower deck foyer



Double guest stateroom



Double guest stateroom



Bathroom



Double guest stateroom



Twin guest stateroom



Twin guest stateroom

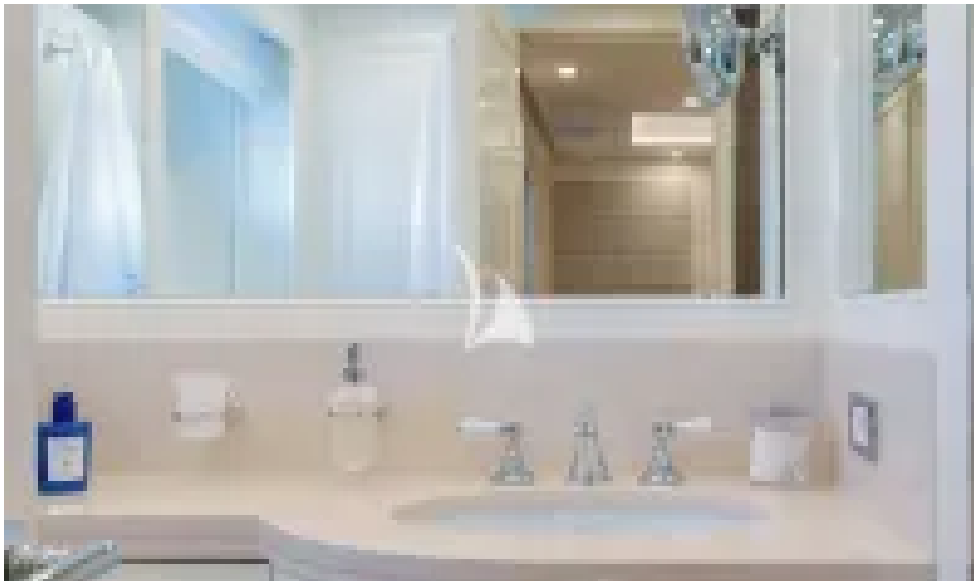

Bathroom



Bathroom



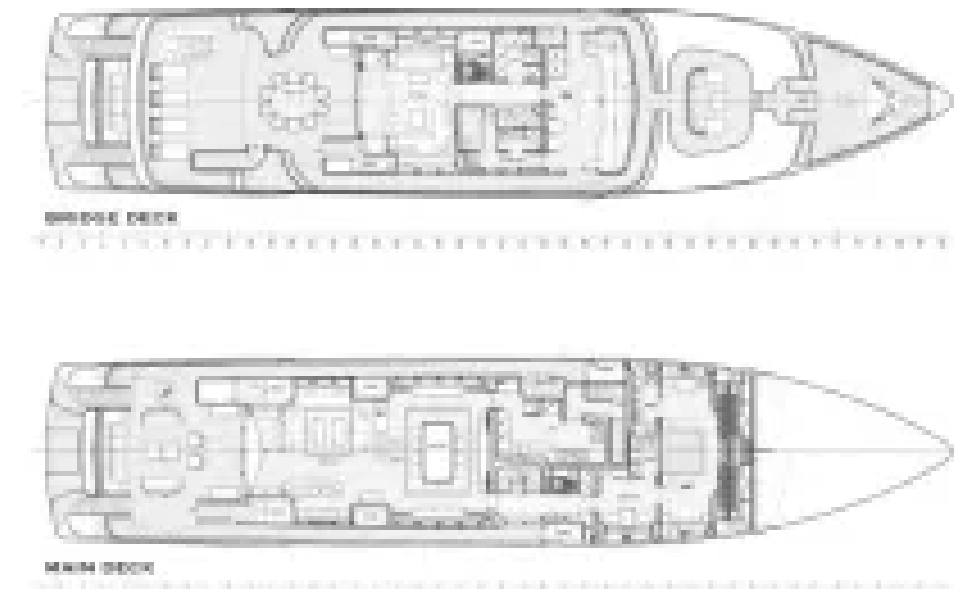









# SPECIFICATIONS

## ACCOMMODATION

**Number of guests:** 12

**Number of cabins:** 5

**Cabin configuration:** 3 Double, 2 Twin, 1 Convertible

**Bed configuration:** 2 Pullmans

## EQUIPMENT

**Engines:** 2 CATERPILLAR 3512C (1.650 HP @ 1.800 RPM) 2 CATERPILLAR C 4.4 "ACERT" (99 KW EACH) 1 CATERPILLAR C 4.4 "ACERT" (65 KW - EMERGENCY)

**Cruising Speed:** 12 knots

**Fuel Consumption:** 250 Litres/Hr

## WATERSPORTS

**Tender + Toys:** CASTOLDI JET TENDER 21 ft x1  
ZODIAC YACHTLINE 440DL 4,4 mtrs 60 HP TENDER x1  
JET SKI SEADOO RXP 300 x1  
JET BOARD RADINN G3 X SPORT x2  
SKI 6,7" JOBE x1  
SKI FOR CHILDS 4,6" JOBE x1  
SOFA TUBE 4 PERSONS JOBE x1  
TOWING TUBE 3 PERSONS JOBE x1  
TOWING TUBE 2 PERSONS JOBE x1  
INFLATABLE KAYAK CHINOOK 100 AQUAGLIDE x1  
INFLATABLE SUP 10,4" JOBE x1  
INFLATABLE PLATFORM 4 X 2 MTRS SEARAFT x1  
SEABOB F5S x2  
ELECTRIC BICYCLE GOCYCLE x1  
ELECTRIC BICYCLE ECOBIKE x1  
SCOOTER NIU x1  
TRANSPARENT CANOE x1  
WINDSURFER BOARD 8,6" MATADORR 3,6" NAISH x1



# LAYOUT

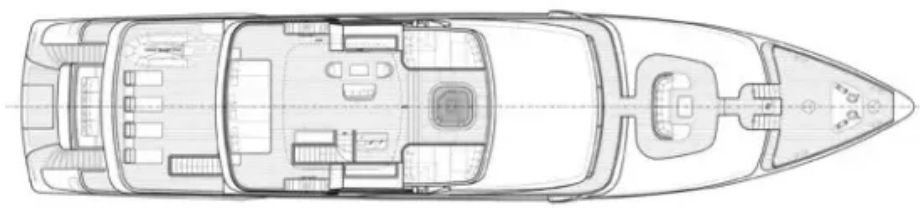

SUN DECK

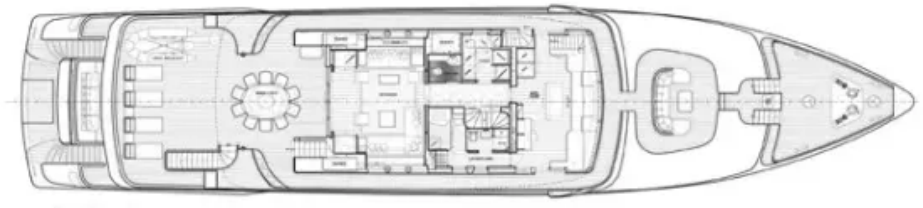

BRIDGE DECK

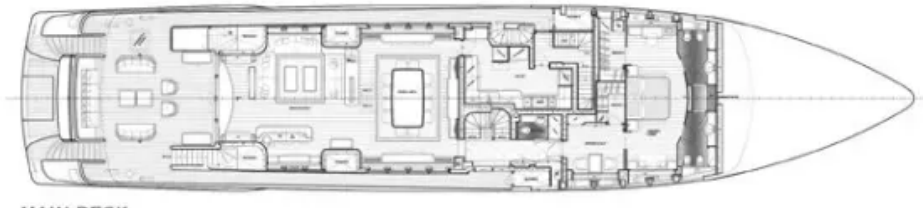

MAIN DECK

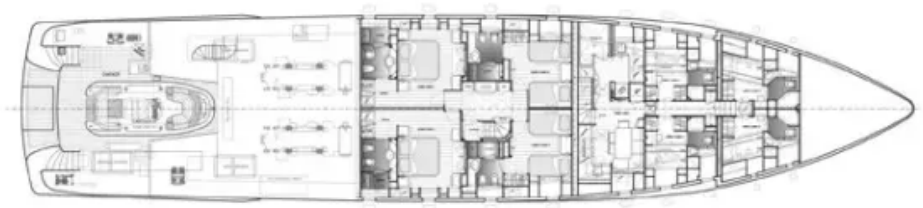

LOWER DECK



## **Disclaimer**

This document is not contractual. All specifications are given in good faith and offered for informational purposes only. The publisher and company do not warrant or assume any legal liability or responsibility for the accuracy, completeness, or usefulness of any information and/or images displayed. Yacht inventory, specifications and charter prices are subject to change without prior notice. None of the text and/or images used in this brochure may be reproduced without written consent from the publisher.